



STARHOTELS[®]
PREMIUM

Michelangelo
FIRENZE

Michelangelo

FIRENZE



Modern style combined with Florentine flair

Like the splendid city of Florence itself, the Starhotels Michelangelo blends classic style and contemporary elegance. Perfectly connected with the S. Maria Novella station and strategically located near the new Opera Theatre and the Stazione Leopolda convention centre, guests will feel at home in the heart of Florence.

The furnishings of its 119 rooms draw inspiration from typical Italian design, combining a chic, modern style with the maximum comfort.

Michelangelo

FIRENZE

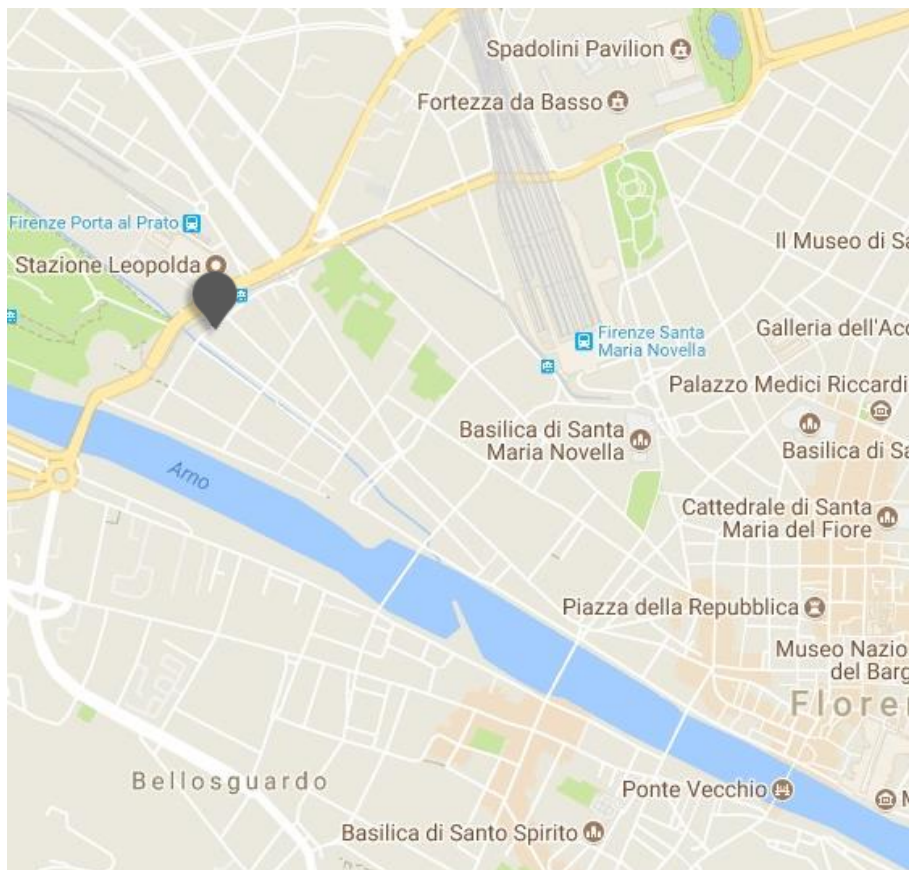

Location

Within easy reach of the historic heart of Florence, perfectly connected with the S. Maria Novella station and strategically located near the new Opera Theatre and the Stazione Leopolda convention centre

Distances

Railway Station: Km 0,7

Highway: Km 6

Airport: Peretola Km 6

Fairground: Km 1

Viale Fratelli Rosselli, 2 - 50123 Firenze - ITALY

T +39 055 27841 F +39 055 2382232

michelangelo.fi@starhotels.it

starhotels.com

Michelangelo

FIRENZE

Restaurant & Bar

The Assaggi by Eataly restaurant offers the finest local dishes, taking advantage of its exclusive partnership with Eataly. The menu varies according to the season and draws inspiration from other Italian regions, as does the wine list.

The bar is the ideal place for a light lunch, a snack before or after a show at the nearby new Teatro dell'Opera, a cocktail or a select wine tasting experience in a refined, exclusive setting.



Michelangelo

FIRENZE



119 rooms

40 Superior
53 Deluxe
23 Junior Suite
3 Suite

The 119 elegant rooms and suites have been recently renovated in a personal, contemporary style with parquet floors and woven leather headboards.



Michelangelo

FIRENZE



Meetings & Events

Meeting rooms: 7
Capacity (theatre style): 230 max

The hotel has 7 meeting rooms which can host up to 230 participants and feature hi-tech equipment.



Michelangelo

FIRENZE

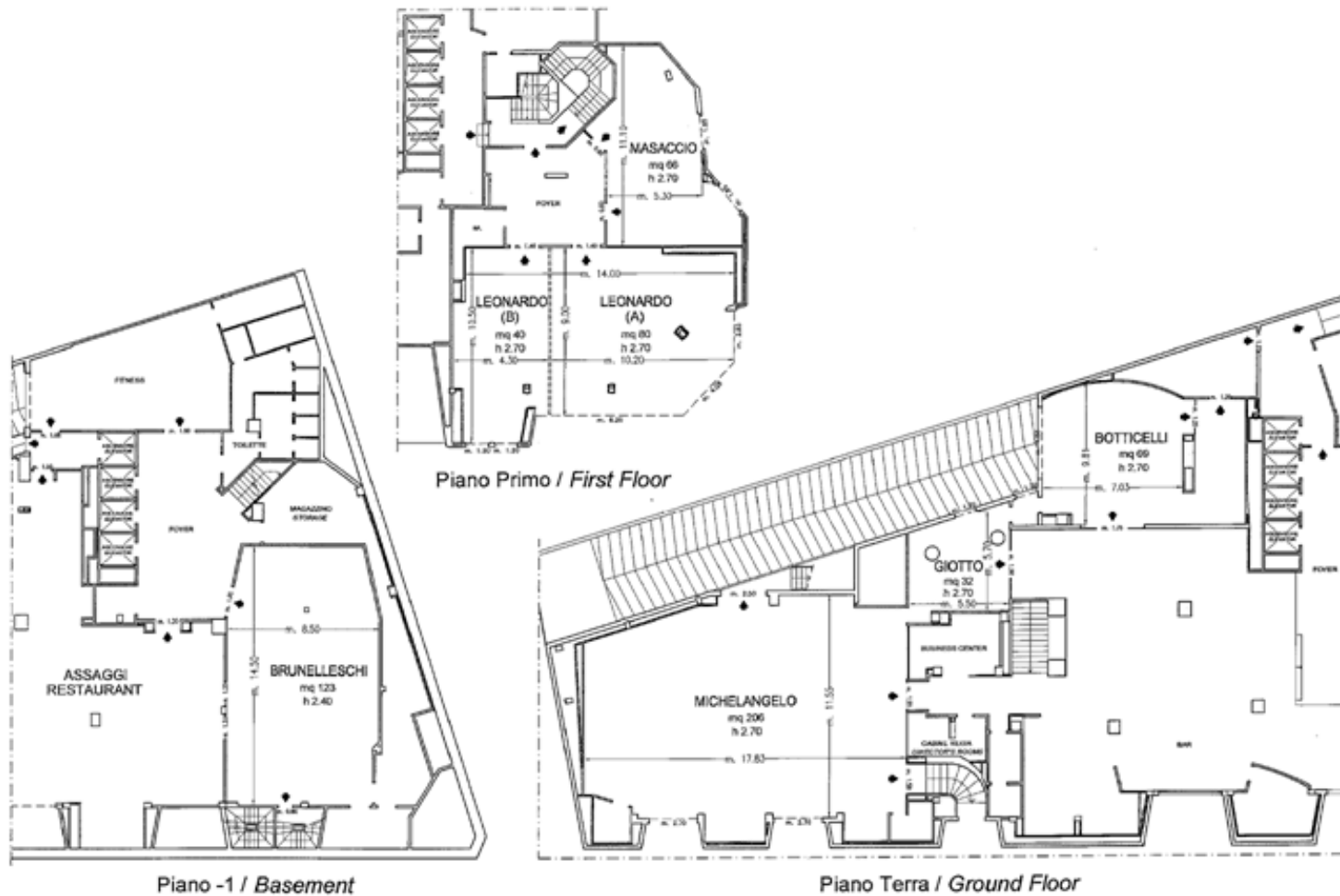

Michelangelo

FIRENZE

Meeting rooms	Area mq / ft.	L x W mt. / ft.	Height mt. / ft.	Theatre	Class room	Conference table/ U-shape	Cabaret style^	Cocktail reception	Banquet
Michelangelo°	206 2216,56	17,83x11,55 58,50x37,89	2,7 8,86	230	90	50	80	230	170
Leonardo (A)°	80 861,1	10,20x9,00 33,47x29,52	2,7 8,86	65	35	28	60	50	35
Leonardo (B)°	40 430,55	10,50x4,30 34,44x14,10	2,7 8,86	35	20	15	-	20	15
Leonardo (A+B)°	126 1355,76	14,00x9,00 45,93x29,53	2,7 8,86	100	55	38	-	90	80
Brunelleschi	123 1323,48	14,50x8,50 47,57x27,89	2,4 7,87	100	50	35	60	90	70
Botticelli°	69 742,44	9,81x7,03 32,18x23,06	2,7 8,86	45	18	18	35	50	40
Masaccio°	66 710,16	11,10x5,30 36,42x17,39	2,7 8,86	40	18	18	30	50	40
Giotto°	32 344,32	5,50x5,70 18,04x18,70	2,7 8,86	-	-	8	-	-	-
Assaggi by Eataly Restaurant°	238* 2560,88	9,50x17,80 + 9,80x8,00 31,00x58,00 + 32,00x26,00	2,2 7,22	-	-	-	-	320	220

° Daylight

^ Cabaret style: Diameter tables cm 140, up to 5 pax each

* Areas with irregular forms